

# Testing and Technical Information

Tested to the global benchmark in barrier safety

**bsi.**  
**PAS 13**  
Code of Practice for Workplace Safety Barriers

How energy (Joules) is transferred from a vehicle impact

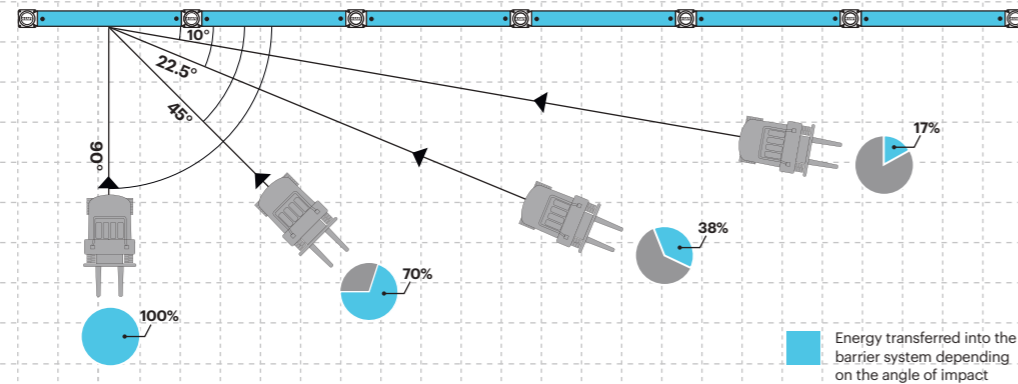

Impact Test on 2000mm Post Centres	Max Vehicle Energy the barrier can withstand at the Impact Angle			
	90°	45°	22.5°	10°
Mid Rail Max Energy (Joules)	15,100	21,350	39,450	86,950

End Post Max Energy (Joules) - 90°	6,900
Mid Post Max Energy (Joules) - 90°	6,900

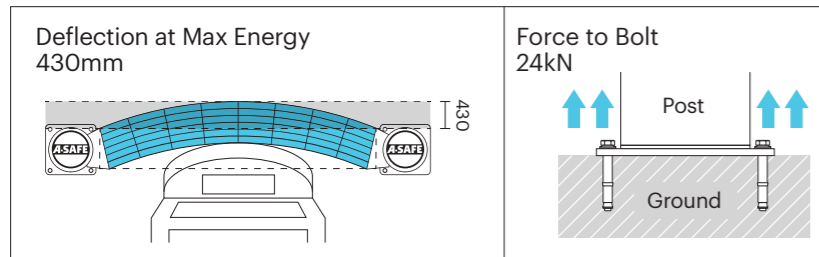

Material Properties	MEMAPLEX™ SUB-ZERO
Temperature Range	-30°C to 0°C
Ignition Temperature	370°C to 390°C
Flash Point	350°C to 370°C
Toxicity	Not Hazardous
Chemical Resistance	Excellent - ISO/TR 10358
Weathering Stability (Grey Scale)	5/5*
Light Stability (Blue Wool Scale)	7/8**
Static Rating (Surface Resistivity)	1015 - 1016 Ω
Hygiene Seals	Yes

\* Weathering scale 1 is very poor and 5 is excellent  
\*\* Light stability scale 1 is very poor and 8 is excellent

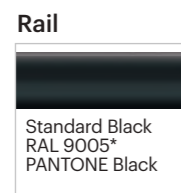
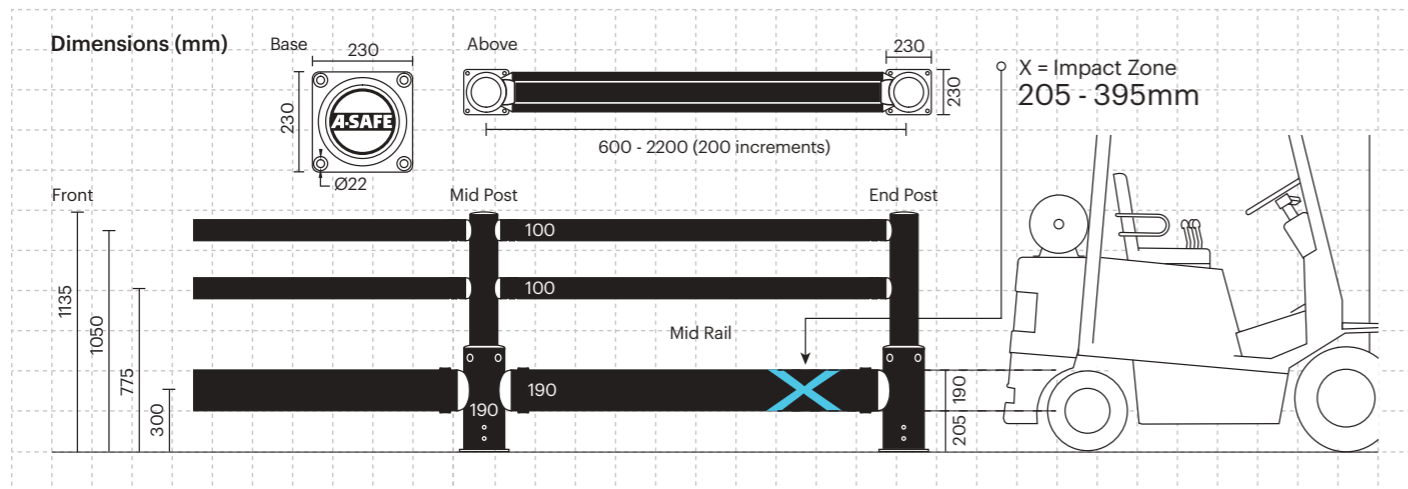

### Colour Combination

\*Please note that the RAL and PANTONE colour listed are the closest match to standard A-SAFE colours, but may not be exact matches of the actual product colour and should be used for guidance only.

# A-SAFE

## iFlex™

### Cold Storage Single Traffic Barrier+

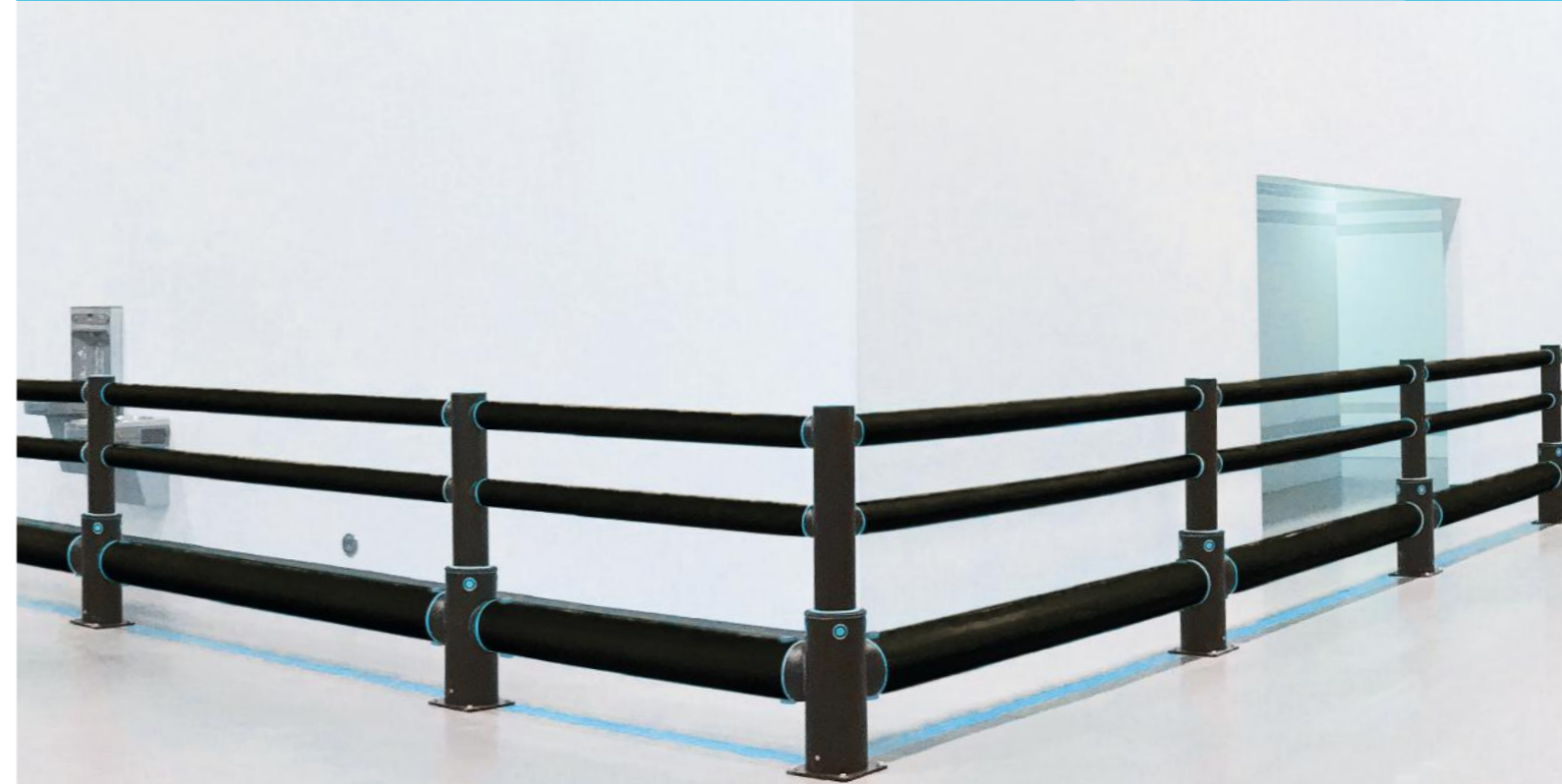

A-SAFE iFlex Cold Storage Single Traffic Barrier+ is designed to protect people, buildings and infrastructure from impacts with forklifts and other vehicles. This high-strength dual-function barrier has been purpose-engineered for applications within sub-zero environments such as cold storage facilities. It delivers supreme performance in temperatures as low as -30°C.

Manufactured from Memaplex™ Sub-Zero, a unique blend of polymers designed to withstand multiple impacts without cracking or fragmenting, iFlex Cold Storage Single Traffic Barrier provides both guidance and physical protection. A heavy-duty traffic rail provides robust resistance against vehicle impacts, while an ergonomic handrail increases the height of the barrier to segregate pedestrian walkways and prevent falls.

Ideal for busy sub-zero environments where people and vehicles share space.





# Engineered for performance

Whether in the resilience, flexibility and in-built memory of our exclusive Memaplex™ material or the unrivalled energy absorption of our unique 3-phase coupling system, a wealth of technical ingenuity goes into every A-SAFE product to ensure that it performs perfectly every time you need it to. We are continuously innovating to solve the greatest workplace safety challenges on behalf of our customers and our numerous patents attest to our industry-leading commitment to research and development.

- Unique sub-zero material science specially developed to perform in very cold conditions, Memaplex™ Sub-Zero is an exclusive composition of the most sophisticated polyolefins and rubber additives, blended for unequalled strength and flexibility.
- Unrivalled resilience through a unique built-in memory that allows material to flex, cushion and reform repeatedly after impacts, saving vast amounts in repairs.
- Huge return on investment from incident prevention and downtime avoidance as barriers, vehicles, floors and equipment do not need replacing or repair.

## MEMAPLEX™ SUB-ZERO

**Advanced Engineering**  
Molecular reorientation during manufacturing creates a unique built-in memory that enables the barrier to fully recover following impacts.

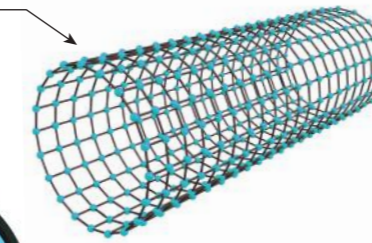

- Revolutionary 3-Layered Material**
- Inner strengthening core
  - Central impact absorption zone
  - Outer UV stabilised colour layer

## Energy Absorption System

A patented 3-phase system that activates sequentially for unparalleled energy absorption

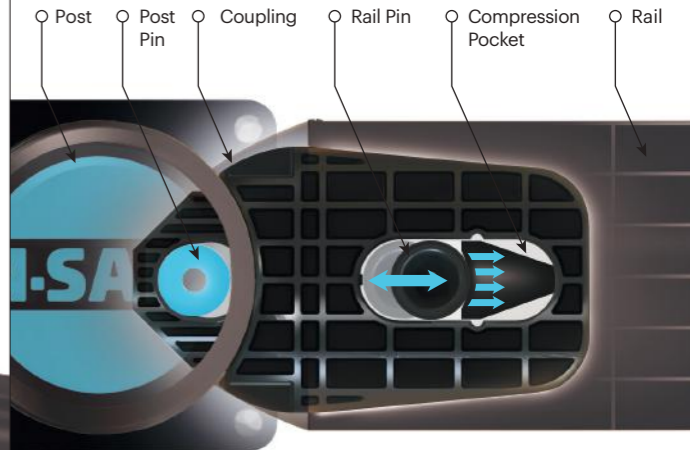

**PHASE 1:** Memaplex™ rail flexes to absorb impact, initiating the rail pin to slide forward and transfer load energy to the compression pocket.

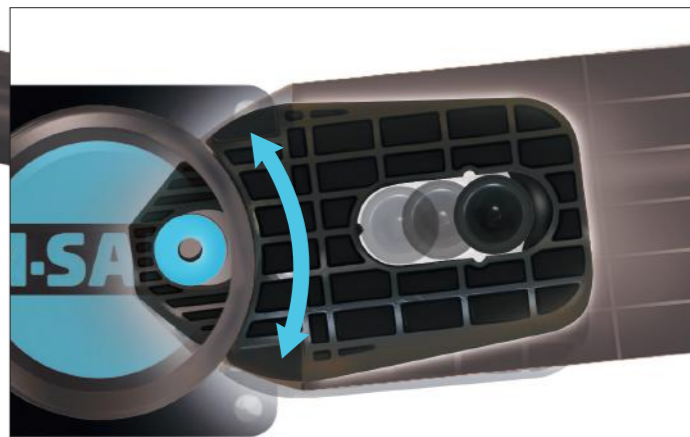

**PHASE 2:** Compression of the pocket continues to disperse energy as the coupling rotates around the post pin to activate further absorption.



**PHASE 3:** At peak energy, the coupling twists further, engaging the post pin and instigating torsion of the post to dispel remaining forces.

- Multi-directional system ensures a streamlined fit into any facility and the removal of hard angles.
- Ultra-low maintenance material is chemical and water resistant, non-corrosive, non-scratch and self coloured so no repainting, rusting, flaking or corrosion.
- Exclusive modularity allows rails and posts to be replaced in-situ without removing adjacent barrier sections.

### Energy Absorption System

Patented system dissipates impact forces through the barrier and away from floors and fixings, preventing costly damage.

Hygiene seals remove ingress points.

Ergonomic design with no sharp edges.

- Zinc nickel coating on base plates as standard, provides advanced protection against corrosion damage.
- No floor damage 80% of impact force is absorbed, transferring just 20% to the floor.
- Environmentally friendly and 100% recyclable.
- Self coloured for enduring high visibility and long-lasting aesthetics with no need for repainting.

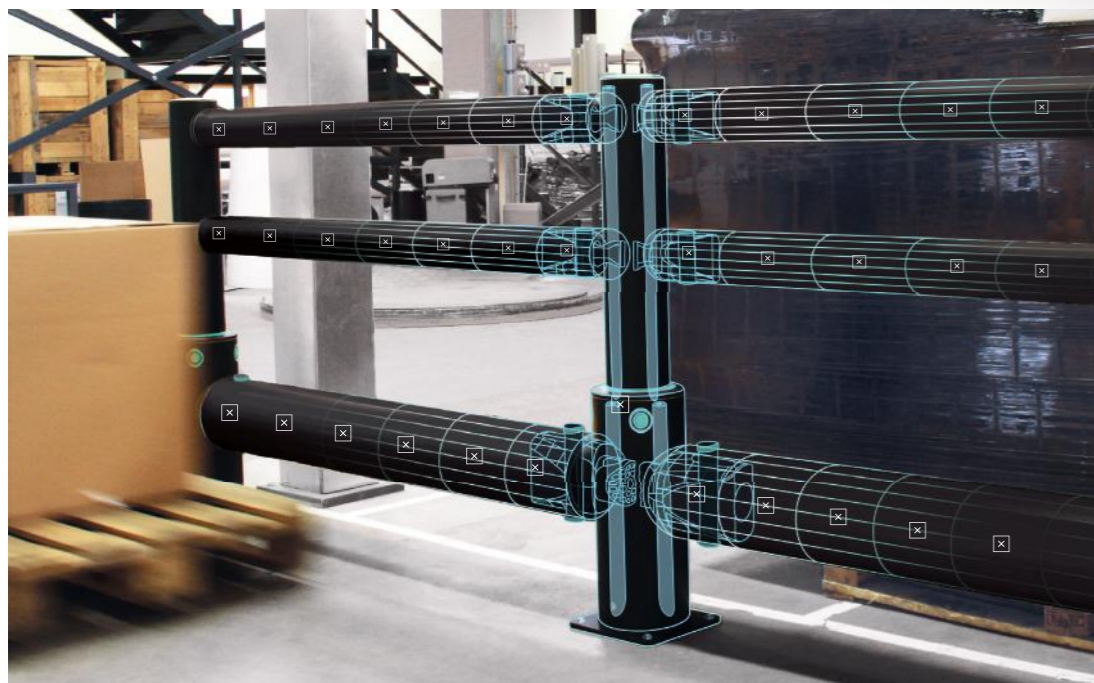

### Climate tested

A-SAFE cold storage products are dynamically impact-tested to PAS 13 standards under realistic climate conditions to ensure they perform perfectly everytime.

### bsi. PAS13

Code of Practice for Workplace Safety Barriers